

## AV601-D

### LCD MONITOR CANTILEVER MOUNT (DOUBLE ARM)



#### DESCRIPTION

AV601-D LCD Monitor Cantilever Mount is stylish, durable and easy to install.

AV601-D allows you to tilt your LCD screen upwards and downwards without changing your viewing angle. The superior design and features make mounting in tight space easy and hassle free.

#### FEATURES

- Quick and easy installation
- Hi-tech design with full versatility
- Include hardware mounting kit
- Cable management
- Superior flexibility and movement
- Alum casting construction
- Nesting arm design allows display to be folded flat against the wall
- The sturdy main frame is movable smoothly even under heavy load
- Double Pivot arm provides full extension & 180 degrees of lateral rotation allowing multiple viewing angles
- VESA standard 75/100 compliant

#### TECHNICAL SPECIFICATION

**SUITABLE SIZE:** 10" to 19" LCD Monitor

**FULL EXTENDED FROM WALL:** 402mm

**DISTANCE FROM WALL:** 68mm (2.7")

**LOAD CAPACITY:** 15kg (33 lbs)

**COLOR OPTION:** Chrome or Grey

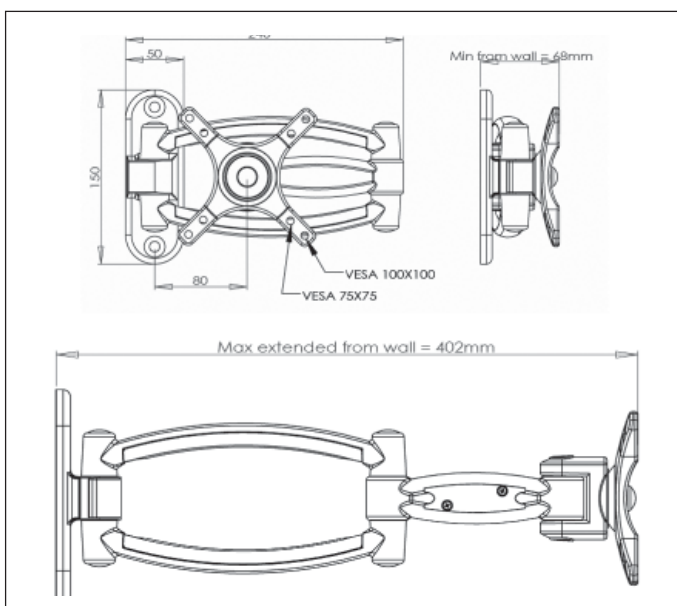

\* Specifications are subject to change without notice.

**ABTUS**